

AREAS

HOUSE	: 176.47m ²
GARAGE	: 35.98m ²
STORE	: 2.80m ²
ALFRESCO	: 35.71m ²
VERANDAH	: 14.02m ²
TOTAL	: 264.98m²
PERIM	: 58.890m
ROOF AREA	: 296.71m²

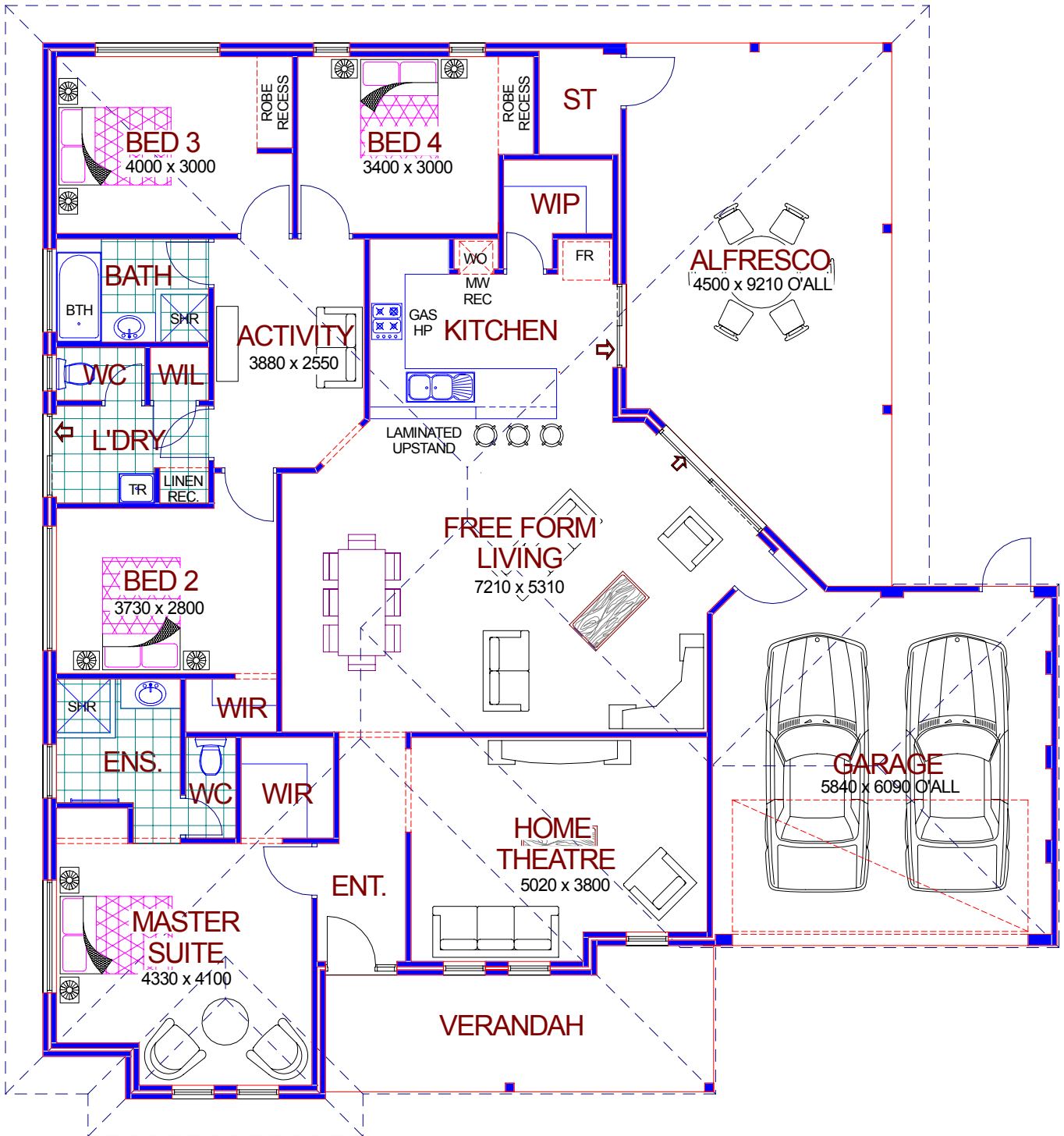

COPYRIGHT MIDCOAST HOMES 2010

GRH Designs

E-mail: ghdesign@earthnet.net.au
6 Ford Street, Woodbridge, 6056
Ph: 0419 880 712

Creating Innovative & Practical Designs that are
Inspired by your Dreams and Vision.

Midcoast Homes
Builders

*We don't try to provide quality - we **INSIST** upon it!*

SERVICING JURIEAN BAY, GREENHEAD & CERVANTES

Phone 08 9652 2707 - Mobile 0418 926 771
Fax 08 9652 2708 - Email midcoast@earthnet.net.au
5 Zircon Street, Juriean Bay - PO Box 672, Juriean Bay, WA 6516

The Moonlight Cottage 2010